

100
0
10
Millimetres
DO NOT SCALE

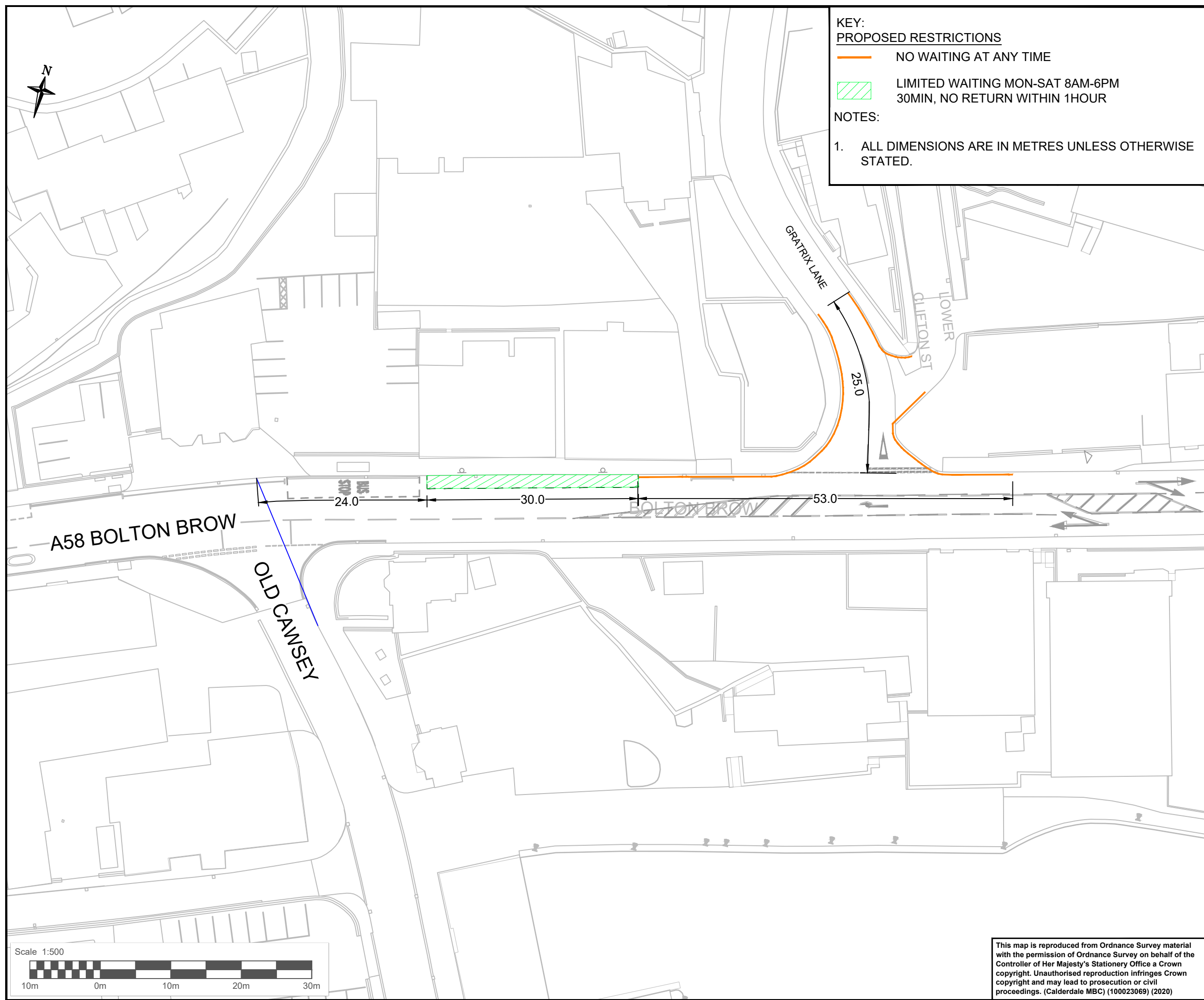

KEY:
PROPOSED RESTRICTIONS

— NO WAITING AT ANY TIME

▨ LIMITED WAITING MON-SAT 8AM-6PM
30MIN, NO RETURN WITHIN 1HOUR

NOTES:

1. ALL DIMENSIONS ARE IN METRES UNLESS OTHERWISE STATED.

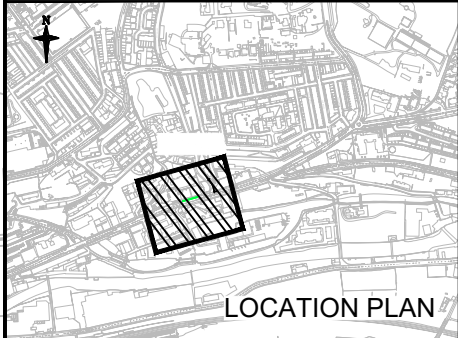

SAFETY, HEALTH AND ENVIRONMENTAL INFORMATION

In addition to the hazards/risks normally associated with the types of work detailed on this drawing, note the following significant residual risks (Reference shall also be made to the design hazard log).

Construction
NONE

Maintenance / Cleaning
NONE

Use
NONE

Decommissioning / Demolition
NONE

ISSUED FOR APPROVAL							
Status	Revision	Drawn	Checked	Reviewed	Authorised	Issue Date	
A1	CO3	GS	PW	SR	RM	20/08/21	
Description Final Issue							
A1	CO4	SA	LA	SR	RM	11/08/22	
Description Final Issue							
A1	CO5	SA	LA	RM	SR	15/08/22	
Description Final Issue							
A1	CO6	SA	MWD	AK	RM	16/08/22	
Description Amended drawing							
A1	CO7	LA	AK	LA	SR	24/08/22	

Drawing Suitability: A1

APPROVED - PUBLISHED

Woodcote Grove
Ashley Road
Epsom
Surrey
KT18 5BW
Tel: +44 (0)1372 726140
Fax: +44 (0)1372 740055
www.atkinsglobal.com

Client: Calderdale Council, West Yorkshire Combined Authority

Project Title: CALDERDALE MBC - CIP

Drawing Title: A58 - SOWERBY BRIDGE EAST TRO PROPOSALS
SHEET 1 OF 1

Drawing Number	Project	Originator	Volume
CMBCCIP	A58SBE	ATK	LTR

Location	Type	Role	Number
A58SBE	DR	ZL	000003

Original Size	Scale	Project Ref.	Sheet	Rev.
A3	1:500	5186038	1 of 1	C07

This map is reproduced from Ordnance Survey material with the permission of Ordnance Survey on behalf of the Controller of Her Majesty's Stationery Office a Crown copyright. Unauthorised reproduction infringes Crown copyright and may lead to prosecution or civil proceedings. (Calderdale MBC) (100023069) (2020)